



# 3M™ Speedglas™ Heavy-Duty Welding Helmet G5-01

To optimise the effective lifetime of your welding equipment and avoid the additional cost of replacement, regular maintenance is important. Replace all damaged parts immediately to ensure correct levels of protection. Below is a helpful overview; always read and follow user instructions.

## Before use

- Helmet and head harness.** Inspect for cracks or any damaged parts. Replace if needed.
- Cover lenses and visor.** To provide the best possible vision, they should be clean and without scratches.
- Face seal.** If the face seal is damaged there is a great risk that contaminated air will get inside the helmet. Verify it's in position and free from splits and tears.
- Welding filter.** Ensure that the low battery indicator is not flashing and check that the sensors are clean and uncovered.
- Breathing tube.** Confirm that the tube is not damaged or leaking any air. To extend the life of the breathing tube, use a tube cover or a heavy-duty breathing tube.

## After use

- Clean the helmet.** Wipe with a moist tissue or cloth, both inside and outside the helmet. If you suspect that the inside of the breathing tube is dirty, it must be changed. DO NOT rinse, immerse in water or clean with solvents.
- Face seal and sweatband.** Remove for additional cleaning as needed and replace if they have splits or tears or whenever they become unhygienic.
- Cover lenses and visor.** Clean with a soft cloth and replace if any pits or scratches occur.
- Breathing tube.** Replace if damaged, deformed or leaking any air.
- Storage.** Store the helmet in a dry, clean area away from direct sunlight, high temperatures and solvents.

## Spare parts and consumables

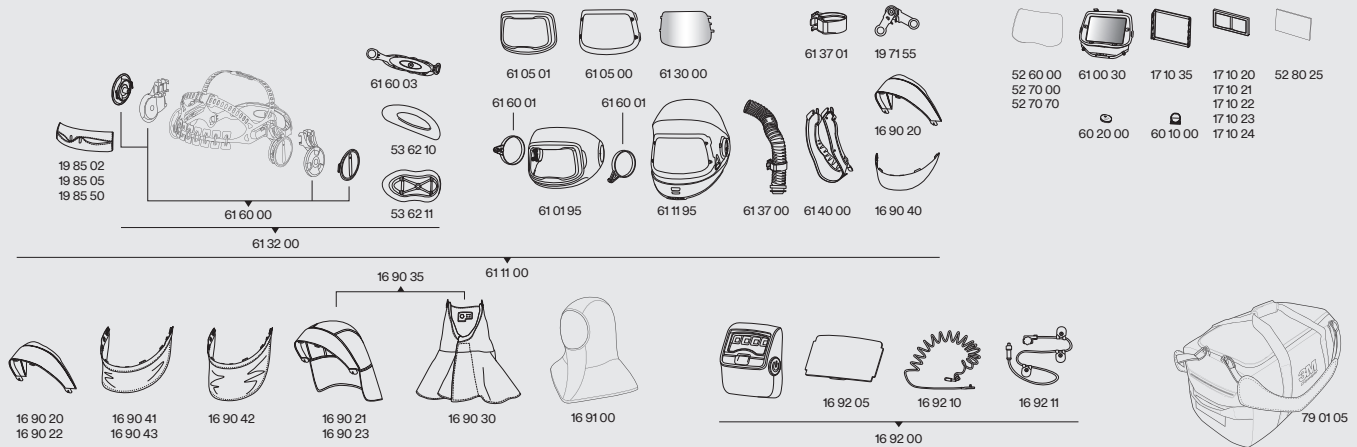

Part No	Description	Part No	Description	Part No	Description
16 90 20	Head Protection Fabric (Small)	17 10 24	Magnifying Lens 3.0X	61 11 95	Inner Shield with Airduct & Airflow Controls , Inc Visor Frame
16 90 21	Head Protection Fluorescent Yellow	17 10 35	Magnifying Lens Holder	61 30 00	Visor Plate Anti-Fog + Hard Coated Pk=5
16 90 22	Head Protection Leather	19 71 55	Hinge Mechanism Pk=2	61 32 00	Head Harness G5-01
16 90 23	Head Protection Fabric (Large)	19 85 02	Sweatband Pk=2	61 37 00	Airduct Breathing Tube (Short) Inc Holder
16 90 30	Shroud	19 85 05	Sweatband Pk=5	61 37 01	Breathing Tube Holder
16 90 35	Extended Cover Kit (Shroud and Large Head Cover Fabric)	19 85 50	Sweatband Pk=50	61 40 00	Face Seal G5-01
16 90 40	Neck Protection Rigid	52 60 00	Lens Cover Outer Standard Pk=10	61 60 00	Pivot & Sliding Mechanism Inc Pivot Knobs
16 90 41	Neck Protection Fabric (Small)	52 70 00	Lens Cover Outer Hard Coated Pk=10	61 60 01	Pivot Ring for Outer Shield Pk=1
16 90 42	Neck Protection Fabric (Large)	52 70 70	Lens Cover Outer High Heat Pk=10	61 60 03	Head Harness Back Part G5-01
16 90 43	Neck Protection Leather	52 80 25	Lens Cover Inner Pk=5	79 01 05	Carry Bag Speedglas Heavy Duty
16 91 00	Head Cape Tecaweld	53 62 10	Head Harness Back Cushion G5-01 (Small)		
16 92 00	Task Light, Inc Mounting Parts & Cables	53 62 11	Head Harness Back Cushion G5-01 (Large)		
16 92 05	Lens Cover Task Light Pk=5	60 10 00	Battery Holder		
16 92 10	Long Power Cable for Task Light	60 20 00	Battery CR2450		
16 92 11	Short Power Cable for Task Light	61 00 30	Speedglas Welding Lens G5-01VC		
17 10 20	Magnifying Lens 1.0X	61 01 95	Outer Shield		
17 10 21	Magnifying Lens 1.5X	61 05 00	Front Cover for Inner Visor		
17 10 22	Magnifying Lens 2.0X	61 05 01	Front Cover for Flip-up		
17 10 23	Magnifying Lens 2.5X	61 11 00	Welding Helmet G5-01, Exc Welding Filter		